

COMPACT DIRT SEPARATOR



Descriptions

The dirt separator with perpendicular CONNECTIONS was created to increase the purification of the fluids in hydraulic systems, removing impurities as iron and slag. The dirt separator has a stainless steel cartridge filter, a big magnet to attract iron impurities, automatic air vent valve and manual drain valve. These components are insulated and have an insulation protection in stainless steel.

Cleaning and maintenance

To function correctly, the dirt separator requires correct maintenance. Close the circuit and download the pressure from the valve, now it is possible to remove the inspection cap, using the supplied key, remove the filtering cartridge and proceed with the cleaning operation.

Operation

To keep the fluid clean and avoid damage to the pumps or the heat generator, a dirt separator must be installed. Dirty water passes through the filter and a magnet placed in an accumulation of settling, when it comes out it is cleaner because the dirt has stopped inside.

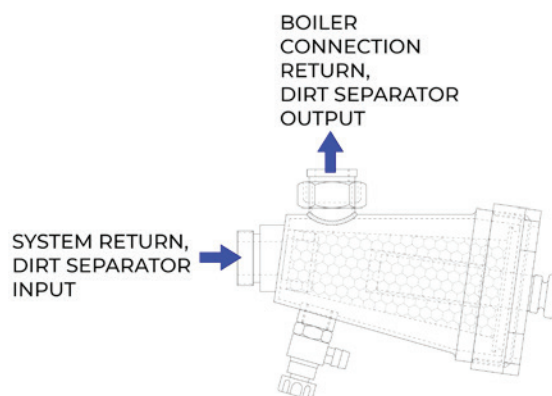

Technical data

CODE	DEFAI2001I
WORKING TEMPERATURE	0°-110°
MAXIMUM WORKING PRESSURE	10 bar
MAXIMUM FLUID SPEED	1,3 M/S
FLUID	water, glycol solutions
DIRT SEPARATOR CONNECTIONS	¾" M ¾" F UNI ISO 228
DRAIN VALVE CONNECTION	¼" F UNI ISO 228

Materials

BODY	stainless steel AISI 304
PLUG	polypropylene
CARTRIDGE FILTER	stainless steel AISI 304
TOP COVER	brass
LOWER SHELL	aluminium
DRAIN VALVE	brass
O-RING	EPDM, non asbestos NBR
MAGNET	neodymium

Installation

As you can see from the picture, this is the right way to install the dirt separator.

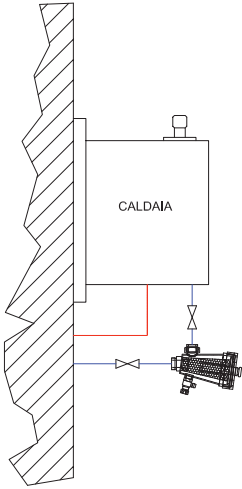

Placement

The positioning of the dirt separator with superimposed connections is correct only when it is in the position indicated in the drawing.

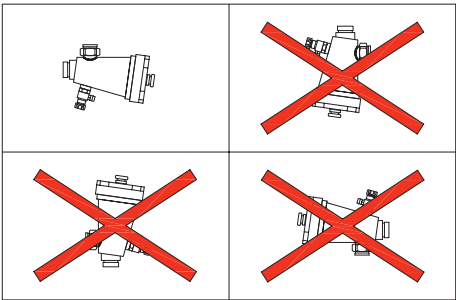

Size

CODE	A	B	C	D	E	F	G
DEFAI2001I	157	113	80	¾" GAS	46	43	17.5

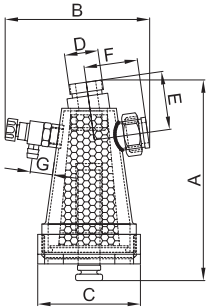

Specification text

Dirt separator. Connections DN20. Nickel plated steel body. Water use fluids, non-dangerous solution glycolates excluded from the scope of Directive 67/548/EC. Maximum glycol percentage glycol 50%. Maximum operating pressure 10 bar. Operating temperature range 0-110°C.

Supplied with:

- Hydraulic seals in EPDM, non-asbestos NBR
- 1/4" drain valve

WARNING!

The symbols on the cap of the separator indicates the presence of magnetic fields, which can cause damage to electronic devices (including pacemakers) that are placed in close proximity.

